

# CFM PICTURE BUTTE

REVISED: February 3, 2025

EFFECTIVE: February 5, 2024

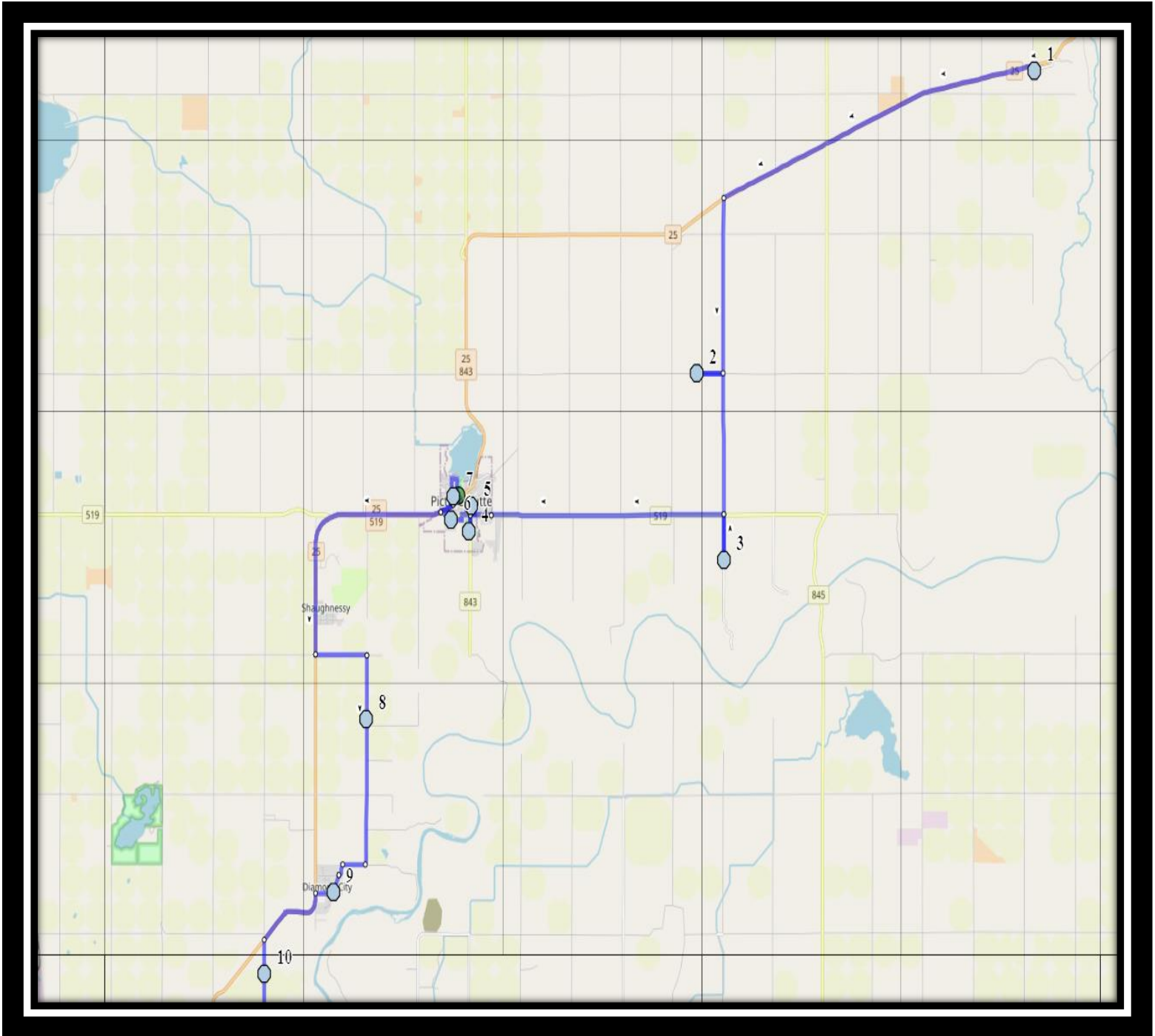

**PM reverse of AM alternate order**

**Catholic Central High East – 405 18 Street South – (403) 327-4596**

**St. Francis Middle School – 333 18 Street South – (403) 327-3402**

**Ecole St. Mary's – 422 20 Street South – (403) 327-3098**

Please arrive 10 minutes before scheduled pick up and drop off times. Times shown may vary due to weather & traffic conditions.

Bus routes and maps are subject to change. For the most up-to-date version, visit [www.southland.ca/lethbridge](http://www.southland.ca/lethbridge).

# CFM PICTURE BUTTE

REVISED: February 3, 2025

EFFECTIVE: February 5, 2024

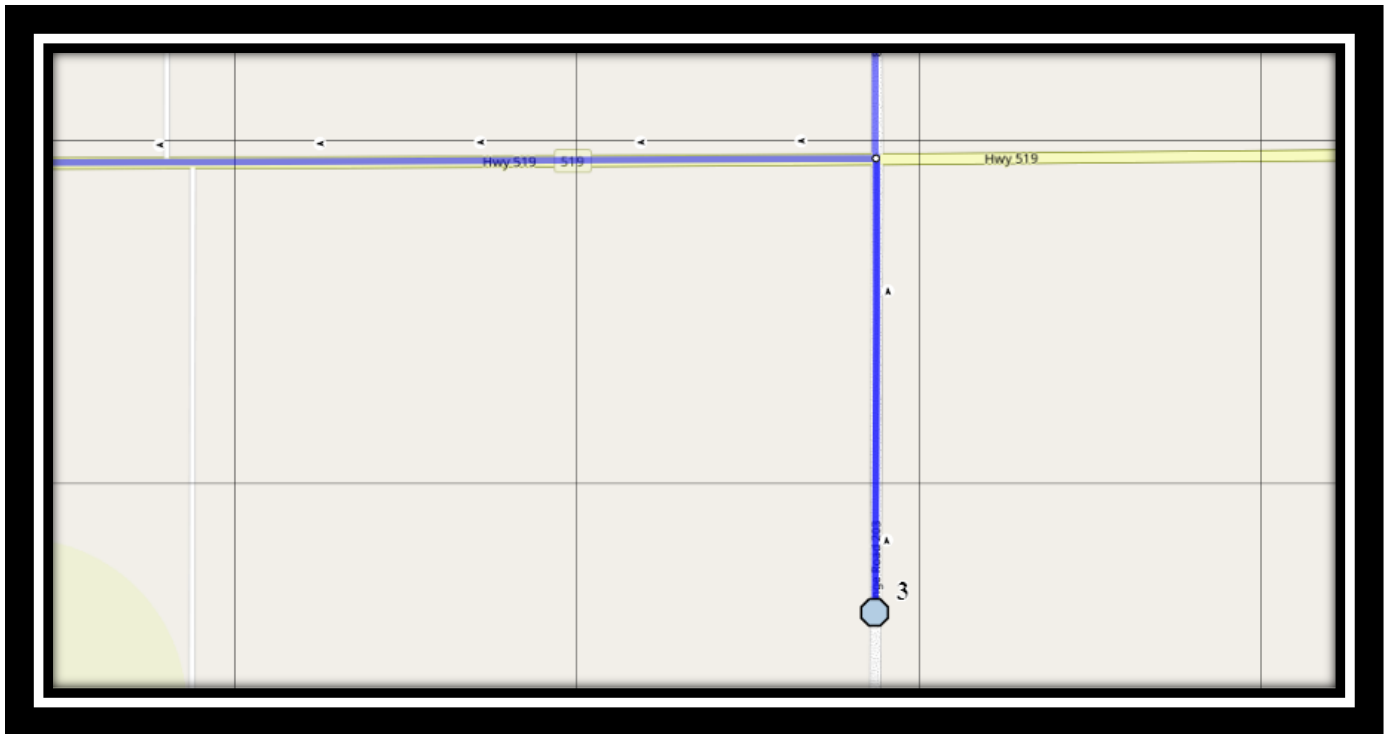
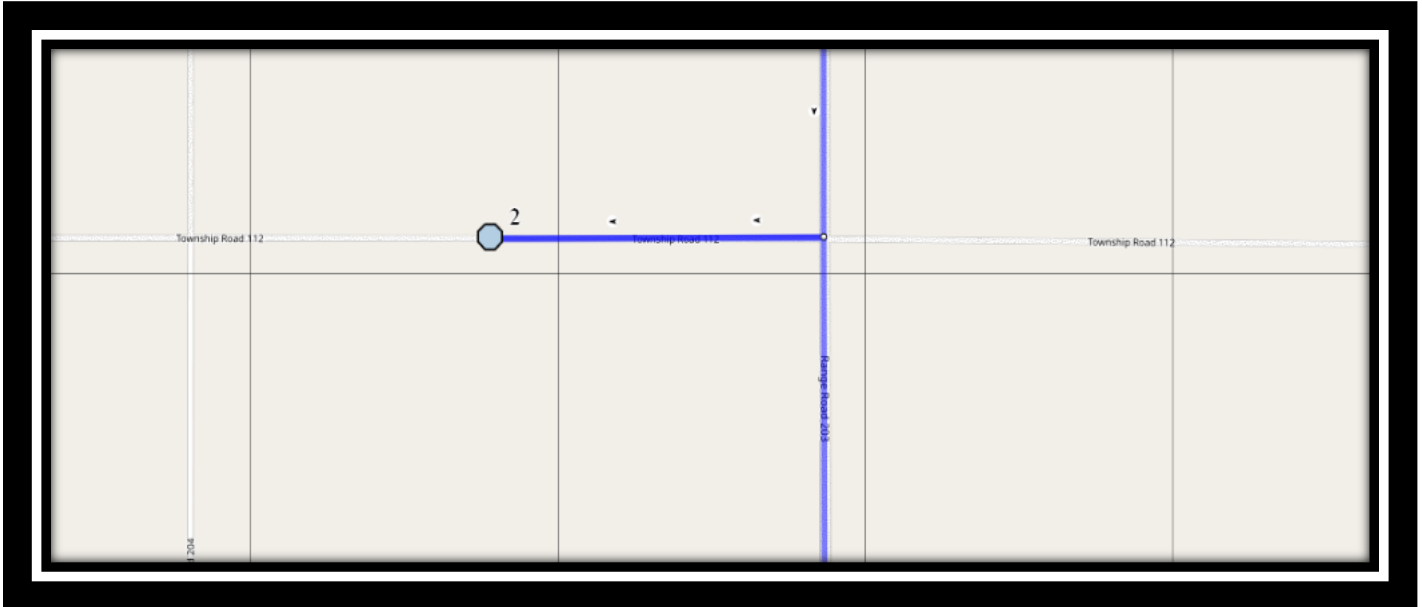

**Catholic Central High East – 405 18 Street South – (403) 327-4596**

**St. Francis Middle School – 333 18 Street South – (403) 327-3402**

**Ecole St. Mary's – 422 20 Street South – (403) 327-3098**

Please arrive 10 minutes before scheduled pick up and drop off times. Times shown may vary due to weather & traffic conditions.

Bus routes and maps are subject to change. For the most up-to-date version, visit [www.southland.ca/lethbridge](http://www.southland.ca/lethbridge).

# CFM PICTURE BUTTE

REVISED: February 3, 2025

EFFECTIVE: February 5, 2024

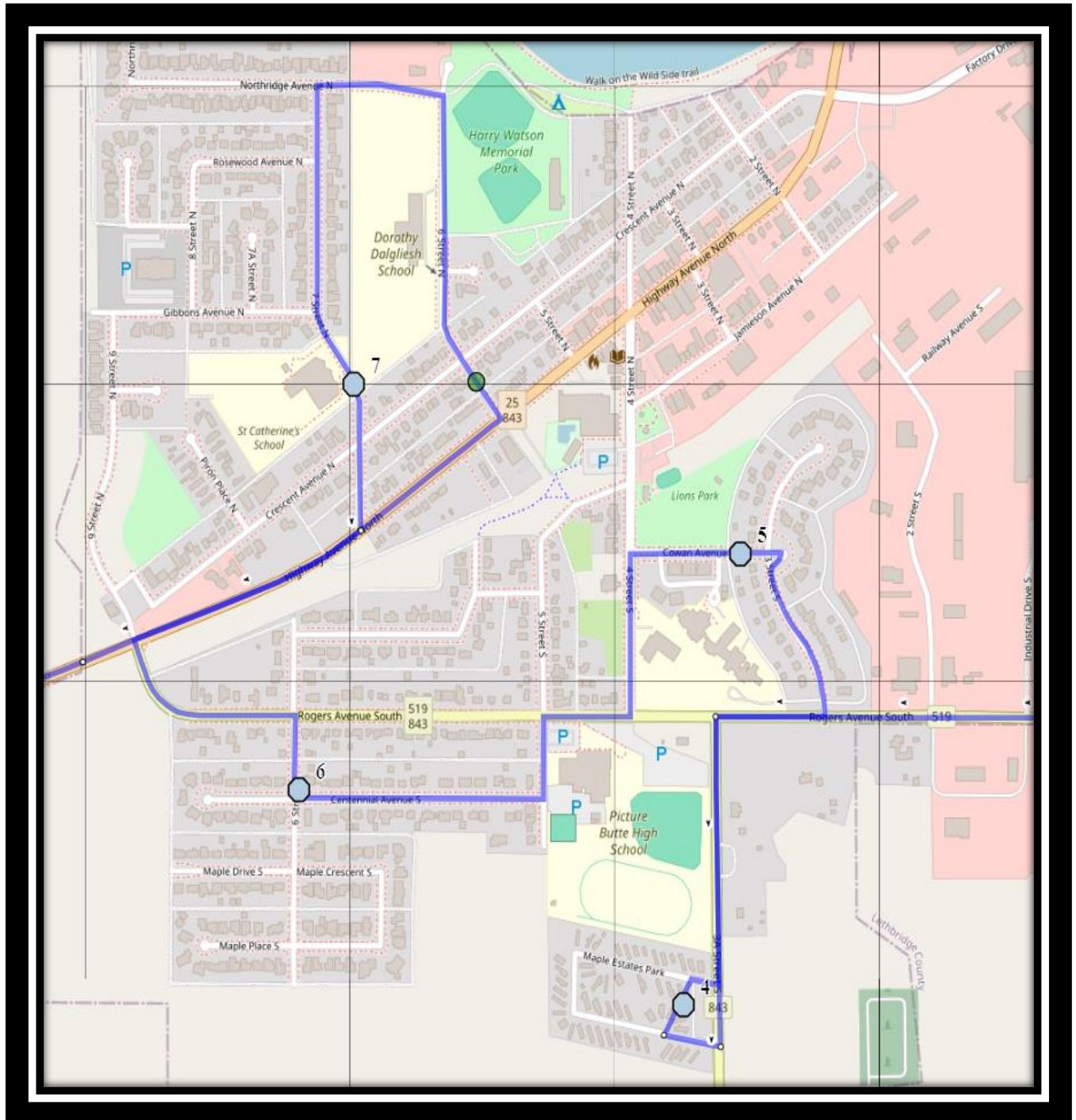

**Catholic Central High East – 405 18 Street South – (403) 327-4596**

**St. Francis Middle School – 333 18 Street South – (403) 327-3402**

**Ecole St. Mary's – 422 20 Street South – (403) 327-3098**

Please arrive 10 minutes before scheduled pick up and drop off times. Times shown may vary due to weather & traffic conditions.

Bus routes and maps are subject to change. For the most up-to-date version, visit [www.southland.ca/lethbridge](http://www.southland.ca/lethbridge).

# CFM PICTURE BUTTE

REVISED: February 3, 2025

EFFECTIVE: February 5, 2024

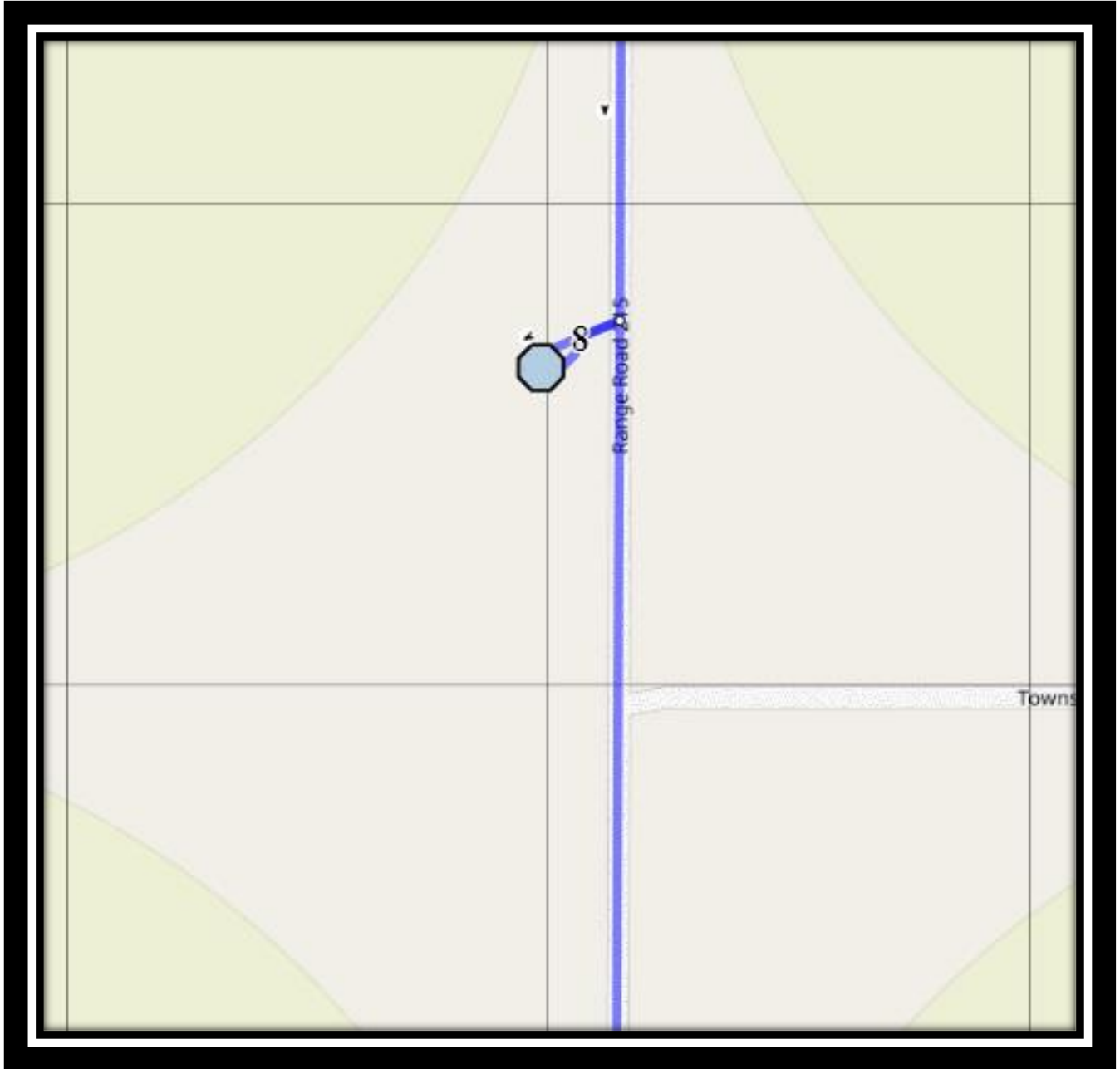

**Catholic Central High East – 405 18 Street South – (403) 327-4596**

**St. Francis Middle School – 333 18 Street South – (403) 327-3402**

**Ecole St. Mary's – 422 20 Street South – (403) 327-3098**

Please arrive 10 minutes before scheduled pick up and drop off times. Times shown may vary due to weather & traffic conditions.

Bus routes and maps are subject to change. For the most up-to-date version, visit [www.southland.ca/lethbridge](http://www.southland.ca/lethbridge).

# CFM PICTURE BUTTE

REVISED: February 3, 2025

EFFECTIVE: February 5, 2024

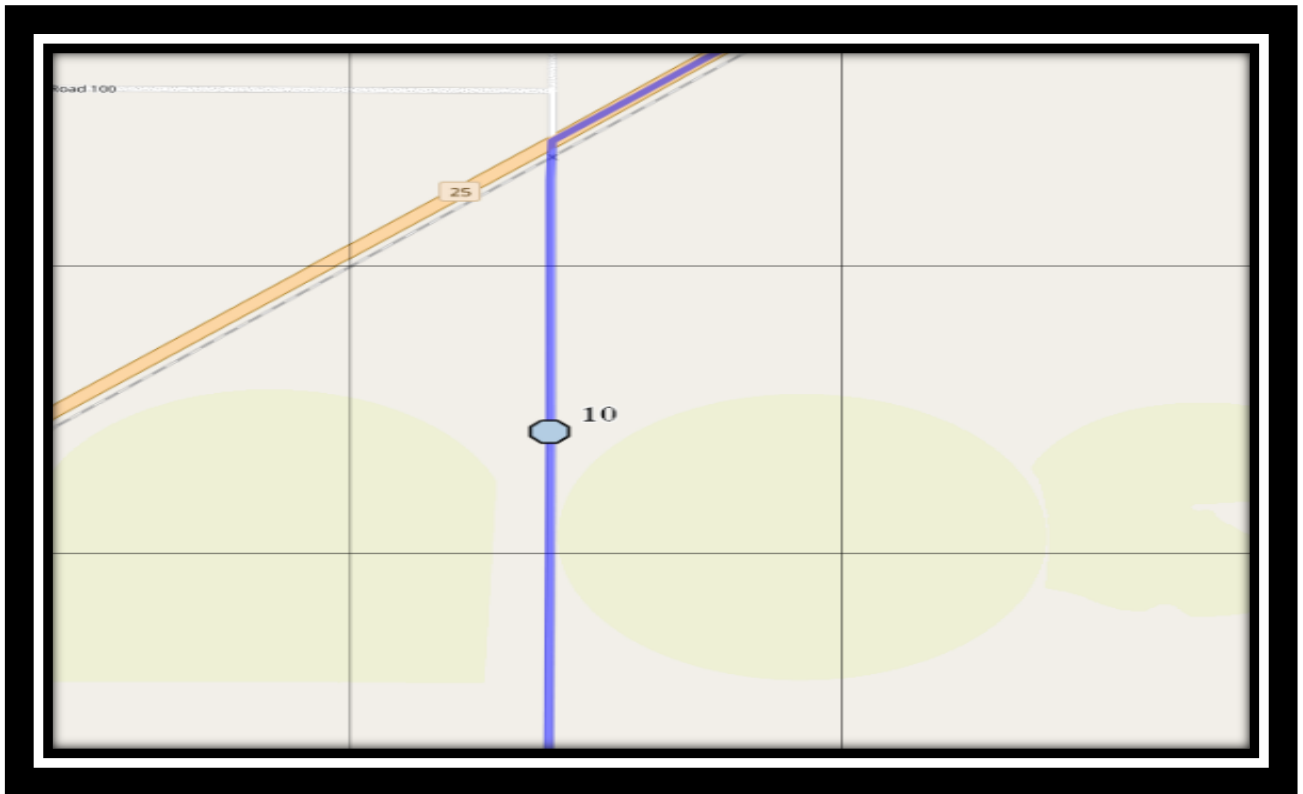
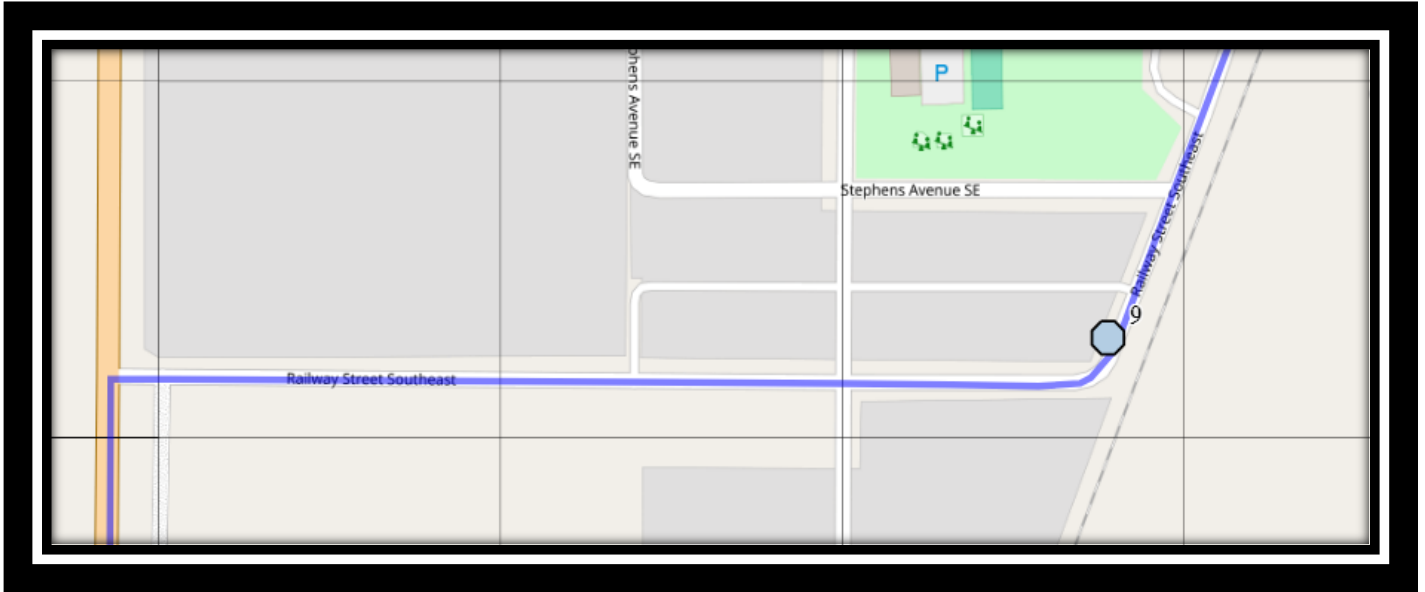

**Catholic Central High East – 405 18 Street South – (403) 327-4596**

**St. Francis Middle School – 333 18 Street South – (403) 327-3402**

**Ecole St. Mary's – 422 20 Street South – (403) 327-3098**

Please arrive 10 minutes before scheduled pick up and drop off times. Times shown may vary due to weather & traffic conditions.

Bus routes and maps are subject to change. For the most up-to-date version, visit [www.southland.ca/lethbridge](http://www.southland.ca/lethbridge).



# CFM PICTURE BUTTE

REVISED: February 3, 2025

EFFECTIVE: February 5, 2024

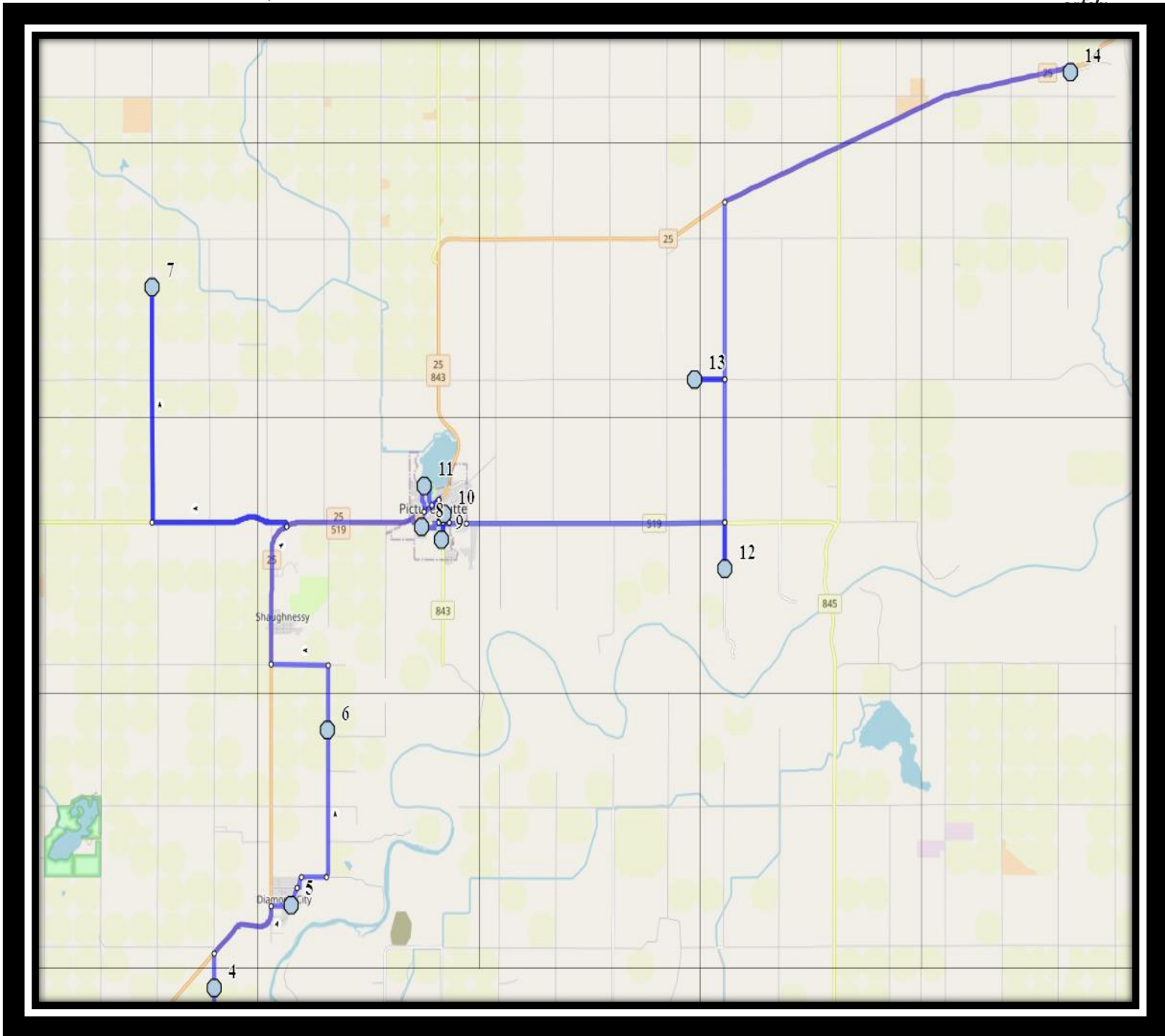

PM Route –

**Catholic Central High East – 405 18 Street South – (403) 327-4596**

**St. Francis Middle School – 333 18 Street South – (403) 327-3402**

**Ecole St. Mary's – 422 20 Street South – (403) 327-3098**

Please arrive 10 minutes before scheduled pick up and drop off times. Times shown may vary due to weather & traffic conditions.

Bus routes and maps are subject to change. For the most up-to-date version, visit [www.southland.ca/lethbridge](http://www.southland.ca/lethbridge).

# CFM PICTURE BUTTE

REVISED: February 3, 2025

EFFECTIVE: February 5, 2024



## Monday – Friday

#1 - 6:35 AM - 112 1 Ave Southeast - Turin

#2 - 6:46 AM - 203046 Township Road 112

#3 - 6:52 AM - 105032 Range Road 204

#4 - 7:00 AM - Maple Estates Park - beside the waste bins

#5 - 7:03 AM - Cowan Ave S. before back alley

#6 - 7:05 AM - Corner of after Centennial Ave @ 6 St S

#7 - 7:09 AM - St Catherine School - power pole at alley

#8 - 7:19 AM - Range Road 215 - 103008

#9 - 7:24 AM - 405 Railway St SE before the bend to Bulyea Ave S

#10 - 7:28 AM - 95036 Range Road 221

#11 - 7:45 AM - Ecole St. Marys - 422 20 St S

#12 - 7:45 AM - St. Francis Junior High - Bus Zone

#13 - 7:45 AM - Catholic Central High School East Campus - Bus Zone

**Catholic Central High East – 405 18 Street South – (403) 327-4596**

**St. Francis Middle School – 333 18 Street South – (403) 327-3402**

**Ecole St. Mary's – 422 20 Street South – (403) 327-3098**

Please arrive 10 minutes before scheduled pick up and drop off times. Times shown may vary due to weather & traffic conditions.

Bus routes and maps are subject to change. For the most up-to-date version, visit [www.southland.ca/lethbridge](http://www.southland.ca/lethbridge).

# CFM PICTURE BUTTE

REVISED: February 3, 2025

EFFECTIVE: February 5, 2024



## Monday – Thursday

- #1 - 3:00 PM - Ecole St. Marys - 422 20 St S
- #2 - 3:00 PM - St. Francis Junior High - 333 18 St S
- #3 - 3:16 PM - Catholic Central High School East - 405 18 St S
  
- #4 - 3:32 PM - 95036 Range Road 221
- #5 - 3:36 PM - 405 Railway St SE before the bend to Bulyea Ave S
- #6 - 3:41 PM - Range Road 215 - 103008
  
- #7 - 3:54 PM - Range Road 221 - turn around in yard
- #8 - 4:06 PM - Corner of after Centennial Ave @ 6 St S
  
- #9 - 4:08 PM - Maple Estates Park - beside the waste bins
  
- #10 - 4:11 PM - Cowan Ave S. before back alley
  
- #11 - 4:14 PM - Northridge Ave Westbound - Alley
  
- #12 - 4:24 PM - 105032 Range Road 204
- #13 - 4:30 PM - 203046 Township Road 112
  
- #14 - 4:41 PM - 112 1 Ave Southeast - Turin

**Catholic Central High East – 405 18 Street South – (403) 327-4596**

**St. Francis Middle School – 333 18 Street South – (403) 327-3402**

**Ecole St. Mary’s – 422 20 Street South – (403) 327-3098**

Please arrive 10 minutes before scheduled pick up and drop off times. Times shown may vary due to weather & traffic conditions.  
Bus routes and maps are subject to change. For the most up-to-date version, visit [www.southland.ca/lethbridge](http://www.southland.ca/lethbridge).



# CFM PICTURE BUTTE

REVISED: February 3, 2025

EFFECTIVE: February 5, 2024



## Friday Early Out

- #1 - 12:25 PM - Ecole St. Marys - 422 20 St S
- #2 - 12:25 PM - St. Francis Junior High - 333 18 St S
- #3 - 12:41 PM - Catholic Central High School East - 405 18 St S
  
- #4 - 12:57 PM - 95036 Range Road 221
- #5 - 1:01 PM - 405 Railway St SE before the bend to Bulyea Ave S
- #6 - 1:06 PM - Range Road 215 - 103008
  
- #7 - 1:19 PM - Range Road 221 - turn around in yard
- #8 - 1:31 PM - Corner of after Centennial Ave @ 6 St S
  
- #9 - 1:33 PM - Maple Estates Park - beside the waste bins
  
- #10 - 1:36 PM - Cowan Ave S. before back alley
  
- #11 - 1:39 PM - Northridge Ave Westbound - Alley
  
- #12 - 1:49 PM - 105032 Range Road 204
- #13 - 1:55 PM - 203046 Township Road 112
  
- #14 - 2:06 PM - 112 1 Ave Southeast - Turin

**Catholic Central High East – 405 18 Street South – (403) 327-4596**

**St. Francis Middle School – 333 18 Street South – (403) 327-3402**

**Ecole St. Mary’s – 422 20 Street South – (403) 327-3098**

Please arrive 10 minutes before scheduled pick up and drop off times. Times shown may vary due to weather & traffic conditions.  
Bus routes and maps are subject to change. For the most up-to-date version, visit [www.southland.ca/lethbridge](http://www.southland.ca/lethbridge).